

## INSTRUCTIONS FOR THE HOME OF THE BRAVE QUILT



The block for this quilt is a basic X shaped 9 patch that should be sewn together in rows as illustrated above. No special technique is needed for this block. It is easy to piece either by machine or hand.

### SUPPLIES REQUIRED

2 Coordinating or contrasting Fat Quarters (will make two identical blocks, or two different blocks depending how you cut the fat quarter)

One strip of 2-5/8" unbleached muslin or plain white fabric

Basic sewing supplies

### CUTTING

Cut an 11" square from one fat quarter. Cut the square into four triangles as shown, using your cutting mat and ruler as a guide.

Cut 4 strips 2-5/8" x 9"

Cut one square 2-5/8" by 2-5/8" from the white or muslin fabric.

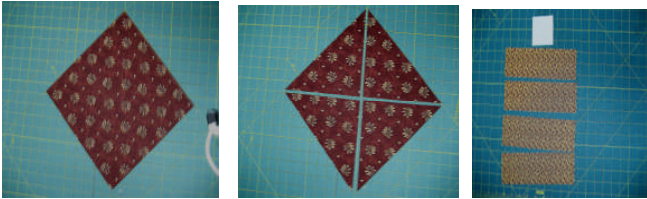

### ASSEMBLY

All seams are to be a 1/4", the finished block will measure 12-1/2" after you square it up.

Being careful not to stretch the bias cut edges, carefully lay a rectangle strip on top of the short side of one rectangle piece. Pin and sew with the rectangle strip on the top.

Press the seam toward the rectangle strip.

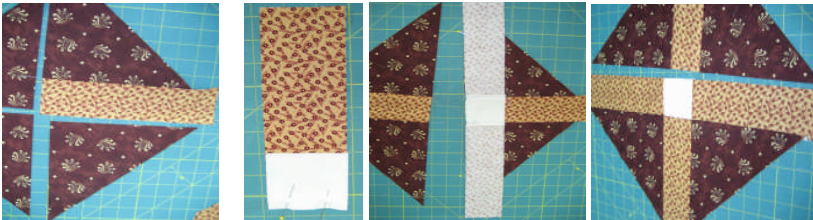

Now sew the other triangle to the other side of the rectangle strip.

Repeat this process until the four triangles have been sewn to each side of the two rectangle strips.

Pin and sew the white or muslin square to the short end of one of the rectangle strips and repeat on the opposite side with the remaining rectangle strip, creating a long strip of fabric.

Pinning right sides together, place the long strip on the top of one of your pieced triangle units, being careful to match the seams at the center square.

Sew and press the seams.

Repeat this process with the last triangle section.

## SQUARE UP

Because we used ample fabric for this block, you will need to square the block to 12-1/2". Trim by using a 12-1/2" square ruler, or your cutting mat as a guide. Using your 12-1/2" ruler, align the ruler with the center square's horizontal points.



## SIGNING THE BLOCK

If you wish to sign the center square, iron a piece of freezer paper to the back of the square, sign with a Sakura Micron Pigma Pen or a Millennium Zig pen, nib #05 as shown in the photo. Please do not use any other pen for signature, as they may bleed when the quilt becomes wet. Using a dry iron, press from the front to heat set the signature. Please do not date the blocks or sign all 15 with your name. You may use family, friends, etc. names on the blocks, or ask your neighbors to sign a block.

## FINISHING INSTRUCTION

### SUPPLIES REQUIRED:

15 completed blocks (you can use blocks all made from the same fabric or each one different)

2-1/4 yards of fabric for sashing & binding.

3 yards of fabric for the back (either muslin or coordinating fabric) Back should measure no less than 52" x 88" so that there is ample room if the quilt is to be quilted by longarm machine.

If you wish to use corner stones, you will need 1 strip of contrasting fabric cut 3-1/2".

Cut TWO strips of sashing fabric 12-1/2" by width of fabric; sub cut into a total of TWENTY-TWO 3-1/2" x 12-1/2" strips.

Cut EIGHT 3-1/2" x 3-1/2" squares of contrasting fabric for the corner stones.

Arrange your blocks the way you want them to appear from top to bottom 3 blocks across by 5 blocks down.

On the first and second block in each row only, sew on 12-1/2" strip, pressing seams toward the sashing strip.

Now sew the first, second and third blocks together to form a row.

Repeat steps 4 - 5 for the remaining 4 rows.

Sew together the following: one 12-1/2" strip, one cornerstone, and one 12-1/2" strip, one cornerstone and one 12-1/2" strip.

Repeat step 7 three more times.

Sew these strips to the bottom of the first FOUR rows, pressing toward the sashing strip.

Assemble the five rows together, matching the corner stone seams with the blocks.

Cut 4-5 strips of sashing fabric, depending on your width of fabric and whether or not you miter your strips, 3-1/2" wide and sew end to end. Cut two strips each measuring 72" (this should be the measurement of the sides of the top).

Sew one 72" strip to the left side of the top, and one to the right side of the top.

Cut 3 strips of sashing fabric 7" wide and sew end to end. Cut these into two strips each measuring 48" across (this should be the measurement across the top and bottom of the top).

Sew one 7" x 48" strip to the top and one to the bottom of the quilt.

Cut 7 strips 2-1/2" wide for the binding.

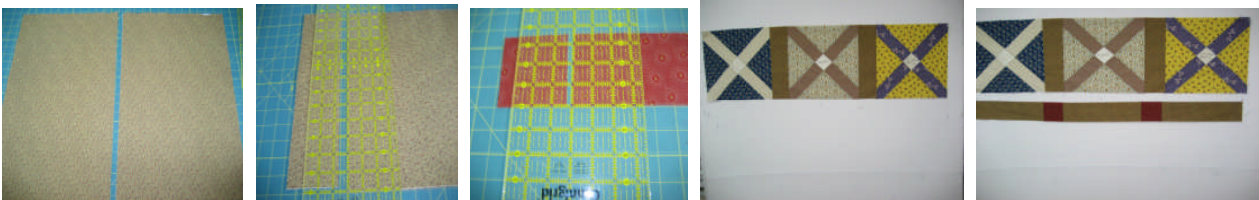

## COMPLETING THE QUILT

If you wish to complete the quilt, you may quilt in any method you prefer, hand-quilting, hand-tied, or machine quilting. If quilting by machine, please take care not to quilt through the center square where signatures appear.



## BINDING

To bind the quilt, sew your binding strips end to end, fold in half and press. Sew the strip onto the front of the quilt, mitering the corners and the end pieces. Hand sew the binding to the back of the quilt.

## LABELS

Labels will be applied by the state coordinator, but if you wish to add your own, that is perfectly acceptable.

## MAILING

Please send your block, top or quilt to the coordinator of your choice, found on the “coordinators” link on the home page. You may e-mail her by clicking on her e-mail address.

If you wish to send to the National Coordinator the address is as follows:

Sandi Carstensen  
1107 Pershing Blvd.  
Clinton, Iowa 52732-5207

Problems or information contact: Sandi Carstensen, [homeofthebravequilts@cis.net](mailto:homeofthebravequilts@cis.net) 563-242-7213